



# NORTHAMERICAN<sup>79</sup>

Progress Report 3  
July, 1979

W. L. ANGE





The 1979 North American Science Fiction Convention  
**NORTHAMERICAN**<sup>79</sup>  
August 30 - September 3, 1979      Louisville, Ky

Guest of Honor  
**Frederik Pohl**  
Fan Guest of Honor  
**George Scithers**  
Toastmaster  
**Lester del Rey**

---

COMMITTEE

Cliff Amos, Chairman  
Shelby Bush, Asst. Program & Publications  
Steve Francis, Treasurer  
Sue Francis, Registration Director  
Irvin Koch, Special Events Director  
Ken Moore, Art Show Co-Director  
Lou Moore, Art Show Co-Director  
Bob Roehm, Program & Publications Director

STAFF

Dan Caldwell, Art Show Assistant  
John Harris, Blood Drive  
Dick & Nicki Lynch, Daily Newszine  
Sharon Maples, Treasurer's Assistant  
Mike Rogers, N3F Room  
Tom Wallbank, Video Room  
Mike Walsh & Janet Caruth, Huckster Room Assistants  
B. J. Willinger, Masquerade

---

NorthAmerican Progress Report #3, July, 1979. Copyright © 1979  
by the Louisville Science Fiction Assn., Inc. Edited by Bob Roehm  
and Shelby Bush. Cover art by Val Lakey. NorthAmerican, P.O.  
Box 58009, Louisville, KY 40258.

# Registration

Membership rates for NorthAmerican are now:

Attending: \$20.00

Supporting: \$ 7.00

At-the-door memberships will be taken at the regular attending rate. Please make all checks payable to NorthAmerican and mail to P. O. Box 58009, Louisville, KY 40258.

Children under 12 will be admitted to NorthAmerican free of charge if accompanied by a paid adult member. If you are bringing a child, please let us know in advance so that we can have a membership badge prepared.

Speaking of membership badges, please wear yours at the convention. Convention activities are for members only, and you will not be admitted to program areas without your badge.

If you have purchased a NorthAmerican membership in your name but now find you won't be able to attend, you can transfer your membership to another person. However, we must have a written authorization to do this, preferably before the convention. Otherwise, there will be delays in registration.

If you have purchased additional guest memberships, please let us know the names for which the memberships will be used as soon as possible.

# Babysitting

Babysitters will be available during the run of the convention. However, we must know in advance the number of hours or during what events you wish to use this service, and also the number of children you have. The babysitting charge will be \$1.00 per hour per child.

# Program

Since NorthAmerican is still two months away, the following schedule is only a tentative one. There will no doubt be a certain amount of re-arrangement due to time conflicts, and of course other participants will be added. Also, the following schedule is only for the main program room. Complete schedules will be printed in the program book.

## THURSDAY

7:30 P.M. Convention opens. Introduction of guests and notables, with brief remarks and announcements.

9:00 The Sandra Miesel Slide Show

10:00 Movies

## FRIDAY

10:00 A.M. What Really Happened at Seacon: Things You Won't Read in the Con Reports. Eva Chalker moderates.

- 11:00 The Editor's Panel: George Scithers, Marta Randall, and James Baen.
- 12:00 Great Fannish Legends, as related by great fannish legends Bob Tucker, Dave Kyle, and Lou Tabakow.
- 1:00 P. M. Science Fiction and Future Politics. Mack Reynolds.
- 2:00 If the North Had Won the Civil War (Oh, You Mean They Did?): SF and the Civil War. A discussion with George Scithers and Cliff Amos. Buck Coulson ~~moderates~~ moderates.
- 3:00 Whatever Happened to Randolph Scott? The Changing Role of the SF Hero(ine). A Bertram Chandler, Jack Chalker, and Gordon Dickson.
- 4:00 "If whoever's programming NASFIC would give me a podium and some time, I might be able to say the things I wanted to say at IguanaCon. But couldn't." --Bill Bowers, Xenolith 2. We did, and he is.
- 5:00 Living With a Writer. Jodie Offutt moderates a discussion with several authors' spouses.
- 6:00 Movies

#### SATURDAY

- 10:00 A. M. Pros and Cons: The Role of the Professional at an SF Convention. David Dvorkin, Edward Bryant, others.
- 11:00 The Paperback (R)evolution: A Discussion Commemorating the 40th Anniversary of Mass-Market Paperback Publishing. D. R. Bensen, James Baen, and Judy-Lynn del Rey.
- 12:00 Those Were the Days: The Way We Were. Frederik Pohl, Jack Williamson, Lester del Rey.
- 1:00 P. M. Heroic Fantasy: New Trends and Old. Andrew J. Offutt, Karl Edward Wagner, Roland Green.
- 2:00 A Nation Divided? A panel discussion moderated by Andrew J. Offutt.
- 3:00 Art Auction: I
- 7:30 Masquerade
- 10:00 Costume Ball: Music, Dancing, Cash Bar. Costumes encouraged but not required.
- 1:00 A. M. Movies

#### SUNDAY

- 1:00 P. M. Banquet, followed by introductions by Toastmaster Lester del Rey and remarks by Guests of Honor Frederik Pohl and George Scithers.
- 5:00 Art Auction: II
- 7:00 Movies
- 7:30 Boarding begins for Belle of Louisville cruise

#### MONDAY

- 10:00 A. M. First Impressions: A slide presentation by Rusty Hevelin.
- 11:00 Writing Outside the SF Field. Juanita Coulson, Joe L. Hehsley, Frank M. Robinson.
- 12:00 New Blood: George R. R. Martin talks to a number of beginning authors making their mark on SF.
- 1:00 P. M. Art Auction: III (until 6:00 P. M.)
- 2:00 Closing ceremonies.

Also attending NorthAmericon, and whose program participation is pending confirmation, will be:

Forrest J. Ackerman	Robert Adams	David Bischoff
Grant Carrington	Perry Chapdelaine	Gene DeWeese
Vincent DiFate	John M. Ford	Charles L. Grant
Phyllis Karr	Val Lakey	Stephen Leigh
Barry B. Longyear	Mike Resnick	Sharon Webb

Many of the authors in the program schedule and listed above will be reading from their own work during the Author's Forum, which will run throughout the convention and is being organized by Gale Burnick. Also, many will participate in Waldenbooks' autographing sessions. Schedules for both these ongoing events will be available at the con.

The NorthAmericon film program will begin each evening following the final program item in the Archibald Room and will continue until near dawn. At the present time, our plans call for showing a number of older films in 16mm and quite a few recent movies in 35mm. Titles and times will be published and posted at the convention. In addition, we have arranged for a special North American premiere of a brand new fantasy adventure film. There is a possibility that this premiere will be shown in a downtown theatre a few blocks from the hotel.

## Help Wanted

Full or Part Time; hours flexible to fit your schedule; low pay, but good working conditions; experience helpful but not necessary; reply to Box 58009.

A lot of fans don't realize how many dedicated volunteer workers it takes to operate a large convention smoothly and efficiently. We have signed up people to cover the important responsibilities of North-Americon, but there are a number of jobs in almost every department where extra hands are wanted. This is where you come in. You can volunteer to spend as many or as few hours per day as you are willing to contribute. If you have any special skills or talents (e.g., can you run a projector, repair a costume, or administer first aid?) or just have general experience in helping out at other conventions, we'd like to hear from you. On the other hand, if you've never done this sort of thing before, but are willing to pitch in wherever needed, your services will also be greatly appreciated.

To volunteer, send us a note with the following information:

1. Your name, address, and phone number;
2. Any experience or skills which will help us find the best position for you;
3. What areas of the convention are you most interested in working on (headquarters, operations, films, art show, masquerade, blood drive, program coordinating, etc.) If you are willing to be a general helper in any area, just write "general" for this item;
4. How many hours and what times of day you will be available.

Feel free to add any further information you think will aid us in placing you. Remember, however, that enthusiasm and dependability are the most important qualifications for most of these jobs. We hope to be hearing from you.



# Masquerade

The Masquerade at NorthAmerican promises to be a grand pageant of Masquers, Monsters, and Magic to begin an evening of Make-Believe. There have been a few revisions in scheduling since the last progress report, so please note carefully the changes in times.

The Masquerade will be held in the Archibald Room of the Galt House on Saturday evening, September 1, at 7:30. All Masquers must assemble in the Water Poet Room for pre-judging by 6:00 P.M. Cool drinks and cool air will be available, but remember, you're going to be in costume for at least three hours; how uncomfortable you want to be is up to you. We will try to have a repair service available for last minute rips and tears, and we'll do our best to accommodate you if you need a chair to sit on, a bed to lie on, or a tether to anchor you down.

Any member of NorthAmerican who has registered for the Masquerade in advance is eligible. You must turn in a completed entry form before 1:30 P.M., Saturday. Sorry, but NO late registrations will be entered. Information sheets and entry forms will be available at the convention registration desk at all hours. Advance copies of the forms, as well as information about the layout of the Archibald Room, etc. can be obtained by writing to the Masquerade Manager.

If you require special lighting, special music or other effects, PLEASE let us know in advance. If you are bringing your own effects (smoke, flash pots, etc.), they must be checked with the Stage Manager by 3:00 P.M. Saturday so that they can be installed on stage before the masquerade begins. All music or sound must be on standard-sized cassettes pre-taped to include 5 seconds of silent lead-in before the sound begins. ALL SPECIAL PRESENTATIONS WILL BE LIMITED TO ONE (1) MINUTE IN DURATION. PERIOD!

We are going to try to make this Masquerade as much fun for the Masquers as for the audience, which means smoothing out as many glitches as possible in advance. Any questions will be promptly answered by writing to the Masquerade Manager.

B. J. Willinger  
8212 Watterson Trail  
Louisville, KY 40299

# Banquet

Complete information on the banquet is available in Progress Report 2. We'd like to remind you, however, that if you want to attend to please order your tickets now. The way sales are going, it is possible that all seats may be taken before the convention. And of course the earlier you buy your ticket the better seat you'll get. Banquet tickets are \$8.50 per person, and payment must accompany the reservation. Tickets will not be mailed out but may be picked up at the registration desk during the con.

# Riverboat Cruise

Our riverboat cruise aboard the Belle of Louisville on Sunday evening is shaping up to be one of the real highlights of NorthAmericon. A half-dozen prominent folksingers will entertain the passengers with songs new and songs remembered, while they refresh themselves with our famous mint juleps. A special booklet with lyrics to many of the songs performed will be given to those riding with us on the Belle. Tickets for the cruise are \$2.00. Since there is room for only 750 aboard the steamer, be sure not to miss the boat--buy your ticket early.

## Special Events

In addition to the events mentioned in the last progress reports, these groups plan to meet at NorthAmericon: FRAZ-APA, CAPRA, and a wargames play-testing group. Topics for discussion groups include the Frefen, The Avengers, Jack Vance, Perry Rhodan, and Star Trek. We are still waiting to hear from people who represent special interest groups, or who want to organize discussion groups.

In conjunction with SFWA and Walden Books, we have arranged for several autographing sessions during NorthAmericon. These will be in the main lobby of the Galt House, and will be open both to convention members and the general public. Exact times and authors' schedules will be announced in the final program.

There has been a great deal of interest in the Take-a-Pro-Out plan, but many of you have not committed in writing. If you want to participate in this project, contact Irvin Koch at the below address. Those who have already expressed an interest should be hearing from Irvin by the end of July. For more information, write to:

Irvin Koch  
c/o 835 Chattanooga Bank Bldg.  
Chattanooga, TN 37402

## Blood Drive

The Louisville Red Cross will be taking blood donations in the Galt House on Saturday from 9:00 until 1:00. Besides blood donors, a few volunteers are needed for clerical work and helping move equipment. If you are interested, please contact us in advance or volunteer to John Harris at the convention registration desk.

## Art Show

Complete Art Show rules were published in Progress Report 2. If you have any questions, please refer to them. If you have a question not covered by the rules, or if you want to enter art, please write (SOON!) to:

Ken & Lou Moore  
647 Devon Drive  
Nashville, TN 37220

# ROC\*KON\*4

OCTOBER 26-28, 1979

LITTLE ROCK, ARKANSAS

Pro Guest of Honor:

## GORDON R.DICKSON

Fan Guest of Honor:

## DALVAN M.COGER

Toastmaster:

## ROBERT L.ASPRIN

Registration

\$8 ADVANCE  
TO OCT. 20 POSTMARK  
\$10 AT-DOOR  
NO CHARGE TO SFWA  
OR ASFA MEMBERS

Hucksters

\$12 FIRST TABLE  
\$10 EACH EXTRA TABLE  
THIS DOES NOT INCLUDE  
CONVENTION REGISTRATION

Banquet

\$7.00

Room Rates

\$18 SINGLE  
\$22 WITH KINGSIZE BED  
\$4 EACH EXTRA BODY

MAKE HOTEL RESERVATION  
DEPOSIT CHECKS TO HOTEL

MAKE REGISTRATION, HUCKSTER TABLE  
& BANQUET CHECKS TO "ROC\*KON\*4"

INFO: P.O. BOX 9911  
LITTLE ROCK, ARK.  
72219



Downtown Motor Inn  
Capitol Ave. @ Gaines  
Little Rock, Ark. 72203  
(501) 376-1364  
(800) 328-5511

\* a Science Fiction Fan Convention



# More NORTHAMERICAN<sup>79</sup> members

699 Christopher Gubelman	755 Russell Cardenal	811 Rick Conley
700 Chris Striker	756 Marian L. Turner	812 Judy K. Rieniets
701 Bob Gobrecht	757 Ruth B. Kaplan	813 Linda Stoops
702 Devra Langsam	758 Diana Gallagher	814 Judith F. Kurman
703 Debbie L. O'Hara	759 Jay Gallagher	815 Patricia Beck
704 Jim R. O'Hara	760 Lester Dunn	816 Christine Beck
705 Jane Bloomquist	761 Evan M. Siegling	817 Ann Morris
706 William McMillan	762 Nancy J. Smith	819 Kendall David Morris
707 Rob Spitzer	763 John J. Novak	820 Dale Shuman
708 David Creek	764 Deborah K. Gerst	821 Gordon R. Dickson
709 Christopher Clark	765 Felicia Kluzak	822 Karen A. Persello
710 Mike Olang	766 Katherine Ewing	823 John Thorsen
711 Robin Brunner	767 Donald Fairhurst	824 Patricia A Munson
712 Judson Horning	768 Nancy Fairhurst	825 Linda F. Hanson
713 Charles Gee	769 Dick Orr	826 Jeff Duntemann
714 Tom Chulski	770 Jenny Orr	827 Carol Duntemann
715 Jean Coyle	771 William D. Conner	828 Robert Lovell
716 Christine Rudock	772 Roberta B. Conner	830 Dalvan M. Cogger
717 Mike Williams	773 Betsey Gardner	831 Greta Avery
718 Shawn Herron	774 Bill Protheroe	832 Kevin Cogger
719 Leslie J. Turek	775 Reita Comer	833 Wilson "Bob" Tucker
720 Fred Isaacs	776 Vincent DiFate	834 Jeff Hull
721 Terry Kostiuik	777 Roseanne DiFate	835 Ruth Proctor
722 Walter Kostiuik	778 Steve Jakab	836 Joe Harmon
723 J. Graham Haughan	779 Jean Jakab	837 Janice Raye Thompson
724 Linda Strickler	780 Merv Binns	838 Barry B. Longyear
725 Brenda Springfield	781 Marian E. Phillips	839 Paul K. Abelkis
726 Velma Cowden	782 Theierry M. Phillips	840 Laura A. Blunk
727 Regina Empie	783 Nancy F. Loughner	841 Jessica Thran
728 Andrew J. Offutt	784 Jamie F. Loughner	842 C. Kay Hinchliffe
729 Jodie Offutt	785 Debra Hussey	843 Diana Dubrall
730 Dale Moeller	786 Bobbie M. Smith	844 Mark L. van Name
731 Irene Moeller	787 Mark W. Bailey	845 Rana van Name
732 Peter Robertson	788 Gail Mathews-Bailey	846 Lynn Mims
733 Craig Jackson, Jr.	789 R. L. Geras	847 Ellen Franklin
734 Karen Jackson	790 Bob Beese	848 Jim Hudson
735 Craig Jackson, Sr.	791 P. J. Beese	849 Jim Alexander
736 Sandy Kahn	792 Joy Harrison	850 Bruce Martz
737 John Millard	793 Eric Kramer	851 Cathy Grzywacz
738 Dennis Jarog	794 Jeff Maynard	852 S. Marie Miller
739 Carol E. Homer	795 Beth Phillips	853 Steven Hamm
740 A. Bertram Chandler	796 Jim Allen	854 Ron Elkins
741 John Comstock III	797 Angela-Marie Varesano	855 Joyce Allen
742 Martha Herman	798 David M. Shea	856 Christopher L. Hodapp
743 Michael Toman	799 Angel Insley	857 Alice Hodapp
744 Arlene Worlidge	800 Cyndi Landers	858 Clay Norris
745 Arthur Sokoluk	801 Richard A. Friedman	859 David Tomlin
746 David Scroggy	802 Judith H. Friedman	860 Val Lakey
747 Bill Schanes	803 Robin Geary	861 Al Glaubinger
748 India Grow	804 Tim Berry	862 Steward Ashty
749 James Grow	805 Sue Berry	863 Ann S. Jones
750 Judith A. Low	806 Bob Wayne	864 Kathyann Meyer
751 Joseph T. Mayhew	807 Donna Struwe	865
752 William C. Marlow	808 Angel Insley	866 Anne Bedford
753 Linda (Linad) Freeman	809 Beverly Kanter	867 Scott Martin
754 John Curlovich	810 Marc S. Glasser	868 Cheryl Wess

869	Jan Hansen	936	Bruce W. Hanson	1003	Joni Stopa
870	J. Barry Zeiger	937	Scott Shoemaker	1004	Arthur Kyle
871	Syndie Johnson	938	Dr. Darrell Richardson	1005	Kerry Kyle
872	Gene DeWeese	939	Cheryl White	1006	Michael Hawn
873	Bev DeWeese	940	Ralph Goldsmith	1007	Jim Rittenhouse
874	Gary Clarke	941	Marzetta Goldsmith	1008	Beatrice Taylor
875	Paula Clarke	942	Reece Morehead	1009	Stephen Leigh
876	Koni Bizzell	943	Paul Oliver	1010	Denise Parsley Leigh
877	David Bizzell	944	Rosa Oliver	1011	Candice Massey
878	Doug Purviance	945	Richard Stafford	1012	Peter Rowe
879	John Burt	946	Carol Stafford	1013	Rick Gellman
880	Rebecca Meluch	947	Charlie Stafford	1014	Franz Zrillich
881	Garry Wilcox	948	Lisa Marie Corley	1015	Sara Core
882	Bobby Socci, Jr.	949	Douglas Siefert	1016	Bill Wu
883	Paul J. Willett	950	Marsha Allen	1017	Claudia Peck
884	Barb Schofield	951	Catherine Dovell	1018	Al Hudson
885	Elizabeth Price	952	Gwendolyn Zak	1019	John Hudson
886	Margaret Price	953	Leigh Kennedy	1020	Frank A. Love
887	Rose Price	954	Carol King	1021	Cliff Biggers
888	Gladys Bohle	955	Sara Tompson	1022	Susan Biggers
889	William Bohle	956	Dan Ludden	1023	David Ludke
890	Melissa Wauford	957	David Steele	1024	Mary J. Morrisey
891	Brad Bertrand	958	William Desmond	1025	Doris Kulfinski
892	Michael Call	959	Karen Shapiro	1026	Charles D. King
893	Debra Call	960	Thomas Owen	1027	James L. Cunningham
894	Donna Dearborn	961	David Zepka	1028	Margaret Currie
895	Robert Rosenberg	962	Bonnie Gordon	1029	Ann Currie
896	Maurine Dorris	963	Frank Robinson	1030	Joseph Aschentach
897	Steve Scherer	964	Jeanne Gomoll	1031	Bill Detlefs
898	Fran Scherer	965	Hank Luttrell	1032	George Koelsch
899	Chuck Miller	966	Diane Martin	1033	Kay Koelsch
900	Lynn Parrish	967	Elan Litt	1034	Elise Adams
901	Vince Zahnle	968	John Kennedy	1035	David Greenslate
902	Jane Taylor Boster	969	Karen Flowers	1036	George W. O'Nale
903	Joyce DeBoard	970	Tiffany Miller	1037	Cindy Laurita
904	Chris Harris	971	David Wilson	1038	John Ward
905	Mark Kunitzky	972	Ronald Zukowski	1039	David Conover
906	Dana Hatfield	973	Felicia French	1040	Jane Hyatt
907	Bonnie Andrews	974	Phil Duncan	1041	Liza Hyatt
908	Sonya Bower	975	Bartara Smith	1042	Emily Hyatt
909	James Leonard	976	Patrick Kennedy	1043	Tom Duncan
910	Tom Cox	977	Rita Coriell	1044	Yuri Duncan
911	Cora M. Slinker	978	Becky Matthews	1045	Fred L. Smith
912	Richard Moore	979	Jan Bogstad	1046	Ed Howard
913	Jean Burn	980	Phil Kaveny	1047	Jane Spurlock
914	Glen Reges	981	James Loughner, Jr.	1048	John Spurlock
915	Janette Howard	982	M. D. Owen	1049	Debra V. Smith
916	Bill Howard	983	Charles L. Grant	1050	Michael B. Smith
917	James Wright	984	Ric Bergman	1051	Sue Hodgson
918	Cynthia Wright	985	B. J. Lukes	1052	Grafton Harper
919	Saschniko Yasutake	986	Robert Jrumhansl	1053	Rich Griendling
920	Robert Dundes	987	Cristi Simila	1054	Candi Strecker
921	Wayne Perin	988	C. Sleepyhawk Simila	1055	Matthew Householder
922	Michael Sestak	989	Ron Robertson	1056	Sue Blai
923	Mercades Crain	990	Sandra M. Anderson	1057	Jennifer A. Goodwin
924	Mel Schmidt	991	Kurk A. Erickson	1058	Terry D. Gray
925	Marta Randall	992	Ray E. Beam	1059	John S. Fusek
926	Randy Cox	993	Mary Ann Beam	1060	Serena R. Fusek
927	David Minch	994	Ed Sunden II	1061	Michael Banks
928	Mary Simon	995	Joan Bledig	1062	Rosa Banks
929	Todd Fluhr	996	Lori Huff	1063	Carol Resnick
930	John Trieber	997	Bruce Coulson	1064	Mike Resnick
931	Doug Kripe	998	Audrey Miller	1065	Robert Speray
932	Pete Roberts	999	Mark Irwin	1066	Patricia Harrod
933	Norman Epstein	1000	Keith Miller	1067	Frank Ward
934	Stephen T. Johnson	1001	A. Watson Miller, MD	1068	Sue Ellen Stout
935	Eric J. Tilbrook	1002	Martha Beck	1069	Gordon Stout

# WE HAVE SOME GREAT MOMENTS FOR YOU IN 1981!



## Our Worldcon Facilities

### Our Worldcon Philosophy

We are not Ringling Brothers, Barnum & Bailey. With a massive ad campaign and a StarWars-type promotion, we probably could deliver an extravaganza that would fill the site of the 1962 Seattle World's Fair. But by avoiding such megalomaniacal schemes, avoiding local advertising, and using escalating membership rates, we can host the kind of WorldCon you want -- a reasonably-sized fannish convention with emphasis on literary science fiction.

In order to provide a great Worldcon, we have been meeting regularly since 1976 to plan operations, programming, publications, and all of the other aspects for which we are responsible. We want the attendees at the Seattle Worldcon to be free to enjoy their convention. It is a big job, to be sure, but we wouldn't be willing to take it on unless we were absolutely certain that we could handle it. We are confident that we can.

We see the WorldCon as an organized meeting place for old friends and new, with activities catering to the needs of the attendees. We want the warm friendly atmosphere of a fan orientated literary convention. We feel that this is what the fan who attends a Worldcon should expect to receive from his hosts... and we intend to provide exactly that!

The Seattle WorldCon Committee has reserved the beautiful Red Lion Inn for the site of the 1981 convention. The Red Lion's 35,000 square feet of function space will easily accommodate the fannish WorldCon we are planning, and it is all indoors! The 14,000 square foot Universe Ballroom and the 7,000 sq. ft. Galaxie Ballroom are complemented by a host of Saturn, Mercury and Apollo rooms with capacities of 25 to 400 fans. There are 72,000 square feet of meeting space in the Red Lion and adjacent hotels, of which 51,680 are currently committed to the Seattle WorldCon.

The Red Lion has more than 700 guest rooms, and an additional 1400 rooms are available in nearby hotels and still more are under construction.

The Red Lion's new tower makes it the largest hotel in the Northwest. The guest rooms are large and luxurious, and the architecture (glass-walled elevators, large terraced pool) is both contemporary and elegant. With three restaurants and two lounges, the Red Lion is everything a WorldCon Hotel should be!

But that is not all! The location is so convenient to Seattle-Tacoma International Airport that you can walk between them if you wish, though free shuttle service is provided. For drivers, there are acres of FREE PARKING available. The pool courtyard and the rustic hewn-timber passageways offer dozens of furnished alcoves ideal for those ubiquitous fangatherings.





## America's Most Livable City

The best time to visit Seattle is late August and early September, with mild and sunny weather. Think about planning your vacation here, since it might be hard to go home without seeing everything, and we've got everything.

It's a twenty minute drive to downtown Seattle. Park in back of the Pike Place Market, our local fantabulous farmer's market and craftsplace. Find real foods and fresh crumpets. Then follow the signs to the Seattle aquarium. Farther down the waterfront is the Washington State Ferry Terminal, including one that goes out to Bremerton, home of the battleship Missouri. Uphill from the Ferry Terminal is Pioneer Square, the original center of Seattle, and underneath Pioneer Square is the Underground Seattle Tour, from when Seattleites rebuilt on the ruins after the great fire of 1890.

Seattle Center, site of the '62 World's Fair, can be reached by monorail (the Golden Age lives!) Aside from the open air concerts, there's the Pacific Science Center, with hands-on type exhibits. The Seattle Art Museum in Volunteer Park is known for the Asian collection. The University of Washington arboretum is as beautiful as it is educational. Or, tour the Boeing 747 final assembly plant. And there are so many restaurants, cafes and expresso shops....

Seattle is between Lake Washington and Puget Sound, for great sailing, boating and fishing. Set between the Cascades and the Olympic Mountains, there are trails for hiking and mountaineering. And Olympic National Park has the only temperate rain forest in this world.

We think you'll enjoy your stay in the Pacific Northwest.

## How to vote for Seattle in 1981

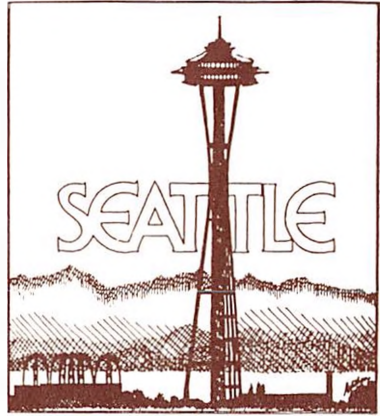

Since WorldCon sites are selected two years in advance, you must be a member (attending or supporting) of SeaCon '79, the 37th World Science Fiction Convention in Brighton, England, in order to vote. Balloting is done by mail, and ballots will be sent out in June, 1979. You may join SeaCon '79 by sending check or money order for \$10 (supporting) or \$20 (attending) to: Tony Lewis, P.O. Box 429, Natick, MA 01760.

You can also help bring the WorldCon to Seattle in 1981 by becoming a pre-supporting member for just one dollar (or more). As a pre-supporting member, you will receive our pre-bid progress report and a discount of at least \$1.00 on your convention membership when we win the bid at Brighton.

Donations of help, advice, and/or money to aid our bidding effort are sincerely appreciated.

Please write: Seattle in 1981  
P.O. Box 24207  
Seattle, WA 98124

1070 James Cooley	1104 Dick Smith	1138 James Rock
1071 Modell Cooley	1105 Olin Osborne	1139
1072 Mark Talley	1106 Gail Walker	1140
1073 Kurt Jaeger	1107 Ava Maureen Durbin	1141
1074 Gerald Corrigan	1108 Roger Sween	1142 Archie Harper
1075 Sherry Katz	1109 Kathleen Herrig	1143 Barry Gehm
1076 Derrick White	1110 Sharon Harris	1144 John Hall
1077 Lee van Deest	1111 Michael Harris	1145 William Francis
1078 Scott Blome	1112 Bill Higgins	1146 Edie Kleinpeter
1079 Linda Saltojanas	1113 Larry Viles	1147 Beth Pointer
1080 Donald Cook	1114 Glenda Sanders	1148 Debra Jean Ulch
1081 Linda Helm	1115 Ruth Kurz	1149 Hank Davis
1082 Jim Durante	1116 Pat Mauk	1150 Howard Mayberry
1083 Joseph Cunningham	1117 Cherie Bloyd	1151 Jacqueline Lee
1084	1118 Melissa Hopkins	1152 John Johnson III
1085 James McGonigle	1119 Diane Morgan	1153 Fred Lukas
1086 Icy Leah Loyall	1120 Stan Pittman	1154 Margaret Moss
1087 Bruce Gardiner	1121 Trubic Turner II	1155 Ralph Moss
1088 Karen Brown	1122 Barbara Wagner	1156 Mike Griffin
1089 Merideth Underwood	1123 Jack Patterson	1157 John Hartling
1090 Glenn McDavid	1124 Marlene Willauer	1158 Cecelia Hester
1091 Mia McDavid	1125 J. Wayne Sadler	1159 Frank Reid
1092 Bill Heron	1126 Rick Lieder	1160 Gary Sinkovits
1093 Walter Miles, Jr.	1127 Arlan Keith Andrews	1161 Tim McGrain
1094 Mary Cowan	1128 Joyce Sammons-Andrews	1162 Valerie Soll
1095 Helen Brunotte	1129 Andy Andrews	1163 Laramie Sasseeville
1096 Floyd Henderson	1130 Patty Barkdoll	1164 Cynthia Hanley
1097 Elise Levenson	1131 Joseph Seiter	1165 Mindy High
1098 Jeffrey Del Papa	1132 Nancy Lebowitz	1166 Ivan Gottlieb
1099 Bill Colsher	1133 Mel Clark	1167 Laurie Gottlieb
1100 Michelle Colsher	1134 Dave Roble	1168 Sandy Roaden
1101 Wallace Neslund	1135 Kathe Sandstrom	1169 Mary Ann Castleman
1102 Donna Neslund	1136 Doug Miller	1170 Virkam Rajadhyaksha
1103 Timothy Stanley	1137 Neil Preston	1171 Lisa Golladay
		1172 Michael Tippens
		1173 Jim Green
		1174 Stuart Hellinger
		1175 D. Jeanette Holloman
		1176 Ronald Robinson
		1177 Vicki Pope
		1178 Steven Johnson
		1179 Stephen Whitmore
		1180 Jackie Whitmore
		1181 Charlie Williams
		1182 Anita Williams
		1183 Mike Weber
		1184 Susan Phillips
		1185 Joseph Lattin
		1186 William Stevens
		1187 Jan Brown
		1188 Linda Blackman
		1189 Scott Bennett
		1190 Gregory Bridges
		1191 J. Clissold
		1192 Pamela Jensen
		1193 Susan Handler
		1194 Carol Banks
		1195 Winga Culler
		1196 Katherine Marschall
		1197 Norman Michal Jr.
		1198 Bruce Michal
		1199 Joyce Smith
		1200 Bill Case
		1201 Scott Elzy
		1202 Clark Denning
		1203 Rusty Burke
		1204 Vikki Stroop

# DISNEYCON 1

February 12-15, 1981

P.O. Box 815 • Brea, California • 92621

# Explore the universe with NOVA

From Asimov to Zelazny, and all the stars between

A galaxy of games, audio recordings,  
speciality publications, and more

The brightest star in the sky

NOVA, F&SF Booksellers

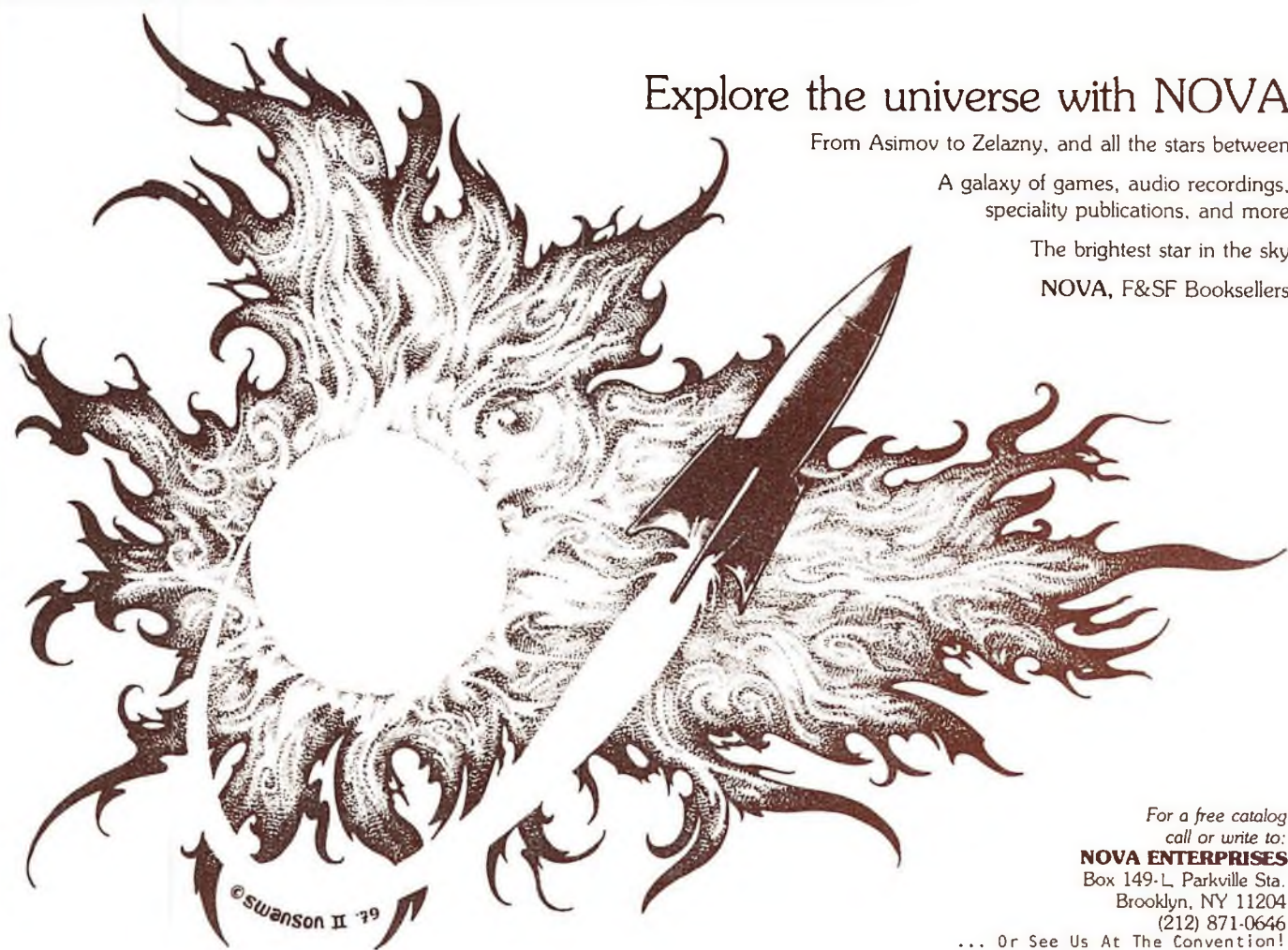

*For a free catalog  
call or write to:*  
**NOVA ENTERPRISES**  
Box 149-L, Parkville Sta.  
Brooklyn, NY 11204  
(212) 871-0646

... Or See Us At The Convention!



# Hotel

As we've said before, we expect North American members to fill the Galt House's 700-plus rooms, so we've arranged with the hotel for a flat \$35 per night for either single or double occupancy. (There's an additional \$5.00 per night charge for each person over two in the room.) We urge you to reserve your room right away if you have not yet done so, because the convention's block of rooms will not be held after August 9, at which time reservations will be accepted from the general public if any rooms remain unbooked. Please use the hotel reservation cards sent to each pre-registered member, or you may phone the hotel direct at 502-589-5200. One night's deposit is required by the hotel for confirmation of your reservation. (Credit card numbers will not be accepted for deposit, although they will of course be accepted for payment at the convention when registering for your room.)

Unfortunately, the Galt House has recently begun installing coin-operated ice machines, so those persons requiring large quantities of ice are advised to contact the hotel staff. We will also have available the address of a 24-hour icehouse that will probably be cheaper.

The floor plan at right will show you where most of the major convention activities will be located. A more detailed version of this map will be published in the program book.

- ① Autographing sessions
- ② Huckster Room
- ③ Author's Readings & Additional Programming
- ⑤ ASFA Room
- ⑥ Publications Office
- ⑦ Main Program, Banquet, Masquerade, & Nightly Films
- ⑧ Art Show
- ⑨ Stage
- ⑩ Video Room & Masquerade Pre-Judging
- ⑪ ⑫ ⑬ Small meeting rooms & Discussion Groups
- ⑭ N3F Room & Fanzine Display
- ⑰ Convention Registration

# Call Us

We've tried to anticipate all your questions and answer them in this and the previous two progress reports. However, if we've missed something and there isn't enough time to write, then feel free to telephone for an immediate reply.

Chairman: Cliff Amos, 502-636-5340

Programming & Program Book: Bob Roehm, 812-288-6204

Membership Registration: Sue Francis, 502-448-6562

Treasurer & Huckster Room: Steve Francis, 502-448-6562

Art Show: Ken & Lou Moore, 615-832-8402

Special Events: Irvin Koch, 404-636-1156

Masquerade: B.J. Willinger, 502-499-1473

# Galt House

## Guide to Meeting and Banquet Room Locations

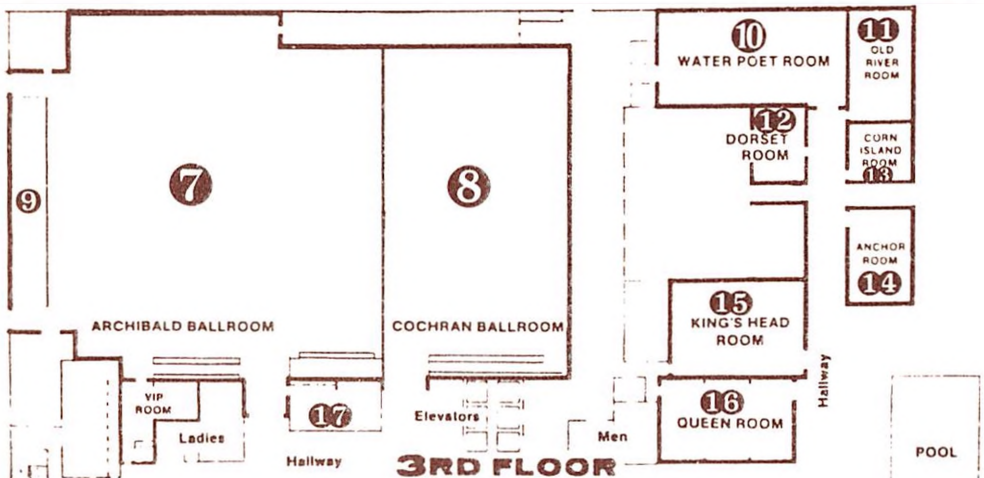
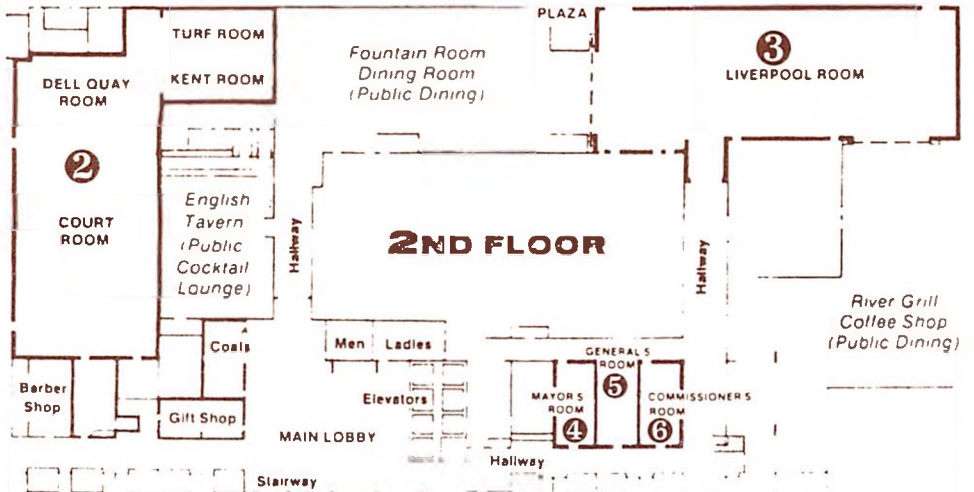
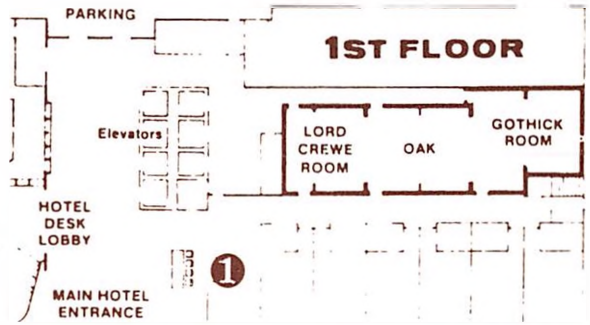

# GETTING HERE

For anyone driving into Louisville, the directions below and the map at right should direct you painlessly to the Galt House.

From I-65 Southbound:

Take St. Louis-3rd St. Exit just after crossing bridge.  
Move quickly to right lane and exit at 3rd St. Follow ramp to River Rd.  
Cross River Rd. on 3rd St. and continue to Main St.  
Turn right on Main, go one block, turn right again on 4th St.  
Enter right hand ramp, then bear left to parking garage.

From I-65 Northbound:

Take St. Louis-3rd St. Exit before crossing bridge.  
Exit at 3rd St. and follow directions above for I-65 Southbound.

From I-64 Westbound:

Remain on I-64 (St. Louis). Exit at 3rd St. and follow directions above.

From I-64 Eastbound:

Exit at 9th St. Turn left on Market St. at foot of ramp.  
Take Market St. 5 blocks to 4th St.  
Turn left on 4th St. and continue 1 1/2 blocks to hotel.

From I-71 Westbound:

Take I-64-St. Louis Exit.  
Follow I-64 to 3rd St. Exit. Exit at 3rd St. and follow directions as in "I-65 Southbound" above.

If you are flying in and arriving at Standiford Field, limosine service is available to the Galt House for \$2.50 per person. (Due to the gasoline situation, however, we could get no guarantee that the price will stay the same for the next two months.) This service is not available on weekends. Regular cab fare from the airport to the hotel (and vice-versa) is approximately \$7.50.

The Greyhound Bus Station is at 7th St. and Muhammed Ali Blvd., and is about six blocks from the hotel.

## On the cover

The striking cover of this Progress Report was done by VAL LAKEY, an artist relatively new to the science fiction field. Her work has appeared in Isaac Asimov's Science Fiction Magazine and Asimov's SF Adventure Magazine, and she will have a cover on an upcoming issue of Analog.



# OHIO RIVER

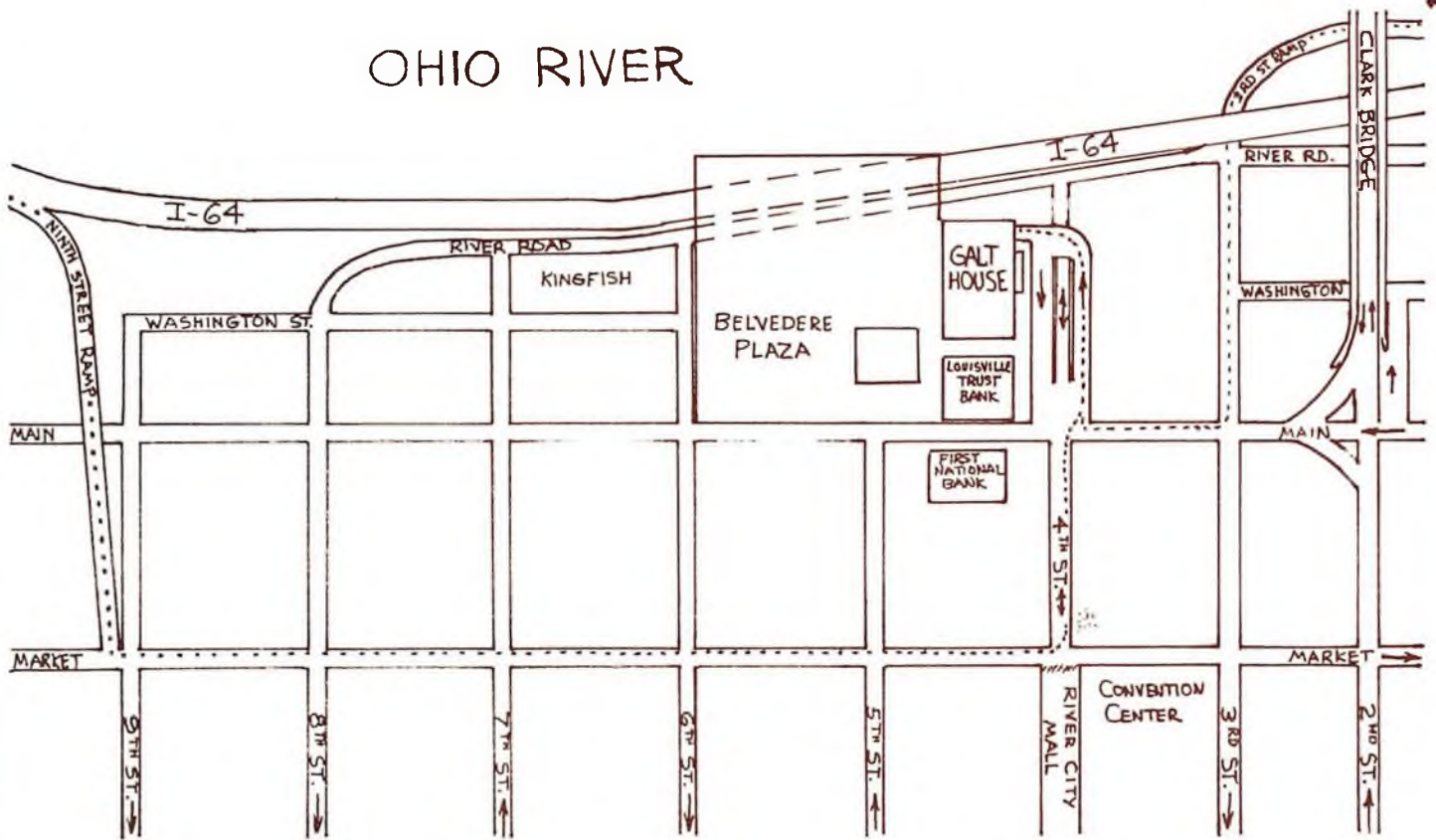

# DOWNTOWN LOUISVILLE

The 38th World Science Fiction Convention...

# Noreascon Two

August 29 - September 1, 1980  
Sheraton-Boston Hotel Hynes Civic Auditorium  
Boston, Massachusetts

- Guests of Honor* Professional: **Damon Knight and Kate Wilhelm**  
Fan: **Bruce Pelz**
- Membership Rates* **Supporting Membership:** \$8.00 at all times  
**Attending Membership:**  
\$30.00 from 1 July 1979 to 1 July 1980  
**Conversion:**  
\$22.00 from 1 July 1979 to 1 July 1980
- International Agents* **Canada:** John Millard, 18-86 Broadway Avenue, Toronto Ontario M4P 1T4, Canada  
**United Kingdom:** Andrew Stephenson, 19 Du Pre Walk, Wooburn Green, High Wycombe, Bucks HP10 0QJ, United Kingdom  
**Australia:** Robin Johnson, G.P.O. Box 4039, Melbourne, Victoria 3001, Australia
- Payments sent directly to us should be in U.S. currency. Payments to agents should be for the equivalent amount in the agent's local currency. All checks may be made payable to **Noreascon II**.
- Advertising Deadlines* Progress Report 3 22 September 1979  
Progress Report 4 8 February 1979  
Please write for complete advertising rate information.
- Voice of the Lobster* A fanzine for those interested in the details of Worldcon planning. Subscriptions are 50¢ per issue; \$2.00 for all issues published, with free copies sent to those whose letters are printed.

**Noreascon II, Box 46, MIT Branch Post Office, Cambridge MA 02139 USA**

van  
Vogt  
says,  
"My favorite  
farthest out  
story. . . ."

Over 32

Magnificent  
Illustrations

© 1978 Bob Maurus



## BATTLE OF FOREVER

by

A.E. van Vogt

A.E. van Vogt

A.E. van Vogt

A.E. van Vogt

- Read at your library
- Order through your bookstore

•Wholesalers & Retailers:

**F. and S.F. Book Co.**

P.O. Box 415  
Staten Island, N.Y. 10302

**Rusty Hevelin**

Huckster Rooms  
[Here and there]

and, such retailers as:

**Vintage Books Unlimited**

Western Gateway Shopping Center  
1901 Russelville Road  
Bowling Green, Kentucky 42101  
(502) 843-1674

•Write Authors' Co-op Publishing Co.

Rt. 4, Box 137 Phone (615) 646-3757

Franklin, Tennessee 37064

§Trade edition \$9.95

§Signed, numbered edition \$14.95

*Please! Keep watching for those fabulous John W. Campbell Letters*

[We're working hard getting them together (and need all help compiling from 1930's through 1971)]

*Available soon!*

for first time on the North American Continent

### THE LAUGHING TERRAN

by

Perry A. Chapdelaine

Chapdelaine has had three novels published in England (*Swampworld West*, Elmfield Press, hc; *Coronet*, pb; *Mondadori*, pb, Italian translation — *The Laughing Terran*, hc, Robert Hale Co. — *Spork of the Ayor*, hc, Robert Hale). He has appeared in numerous English anthologies, latest being *Pulsar 2* (out in November 1979) and was published originally in *Pohl's If*, and *Campbell's Analog*. Limited, signed and trade, hc, editions will be available

soon at *Authors' Co-op, Inc.*

*Photo-composition courtesy of  
AC Typesetting Services  
subsidiary of Authors' Co-op, Inc.*

We also do  
writing  
publishing  
and correcting



# Short Notes

During NorthAmerican, the city of Louisville will be holding the International Heritage Festival on the Belvedere (the park next to the Galt House). Jointly sponsored by ten ethnic groups, the Festival promises to be great fun. If you would like to hear a mariachi band, dance a polka, sample exotic food and drink, or just escape from the convention for a little while, just step outside the hotel door. Admission to the festival is free and will be held from noon until dusk Friday through Monday.

Drinking age in Kentucky and Indiana is 21. This includes beer and wine, as well as the "hard stuff." Keep this in mind if you venture out of the hotel. On the subject of vices, if you're a smoker of tobacco and are from out of state, you can buy cigarettes in Kentucky for about \$4.00 a carton.

The main program areas will be divided into smoking and non-smoking areas. Please observe the signs. Smoking of course will not be permitted at any time in either the Art Show or the Huckster Room. We also ask that no one smoke while food is being served at the banquet.

## Missing People

The following people have apparently moved and left no forwarding address. If you know their current whereabouts, please let us know.  
0310 Ken Fickle (Lafayette, IN) 0663 Willard Preussel (Huntsville, AL)

---

## More members

1205 Michael Townsend	1225 Stuart Stinson	1245 Mary Sayer
1206 Lee Mac Andrews Carroll	1226 Karl Stembol	1246 Joan Winston
1207 Sean Clayton Carroll	1227 Margorie Foster	1247 Margot Van Der Meulin
1208 Kevin Clayton Carroll	1228 Randy Farmer	1248 David Francis
1209 Chip Morningstar	1229 David Vanderwerf	1249 Laura Francis
1210 Janice Johnson	1230 Bethellen Murphy	1250 Steve Waddell
1211 Vicki Lynn Poole	1231 Fred Haskett	1251 Gregory Busing
1212 Lucinda Zarina Seaman	1232 Mark Mitchell	1252 Betty Busing
1213 Kenneth Shepherd	1233 Linda Mitchell	1253 L.T. Shepard
1214 Kathy McNeil	1234 Nigel Sellaes	1254 James Wolfe
1215 Diana French	1235 Anthony Schlisser	1255 Randal Hawkins
1216 Thomas Osburn	1236 Timothy Allen	1257 Lyn Wilderson
1217 Diana Osburn	1237 Steve Carper	1258 Mike Bledsoe
1218 Thomas Osburn II	1238 Linda Saalman	1259 Larry Wilder
1219 Sean Osburn	1239 Ira Donewitz	1260 Arthur Townsend
1220 Rachael Osburn	1240 Donald Prout	1261 Mike Hutto
1221 Leanne Harper	1241 Janet Rajadhyaksha	1262 C.A. Thompson
1222 Jeff Barklage	1242 Gloria Stout	1263 Jim Baen
1223 Warren Cartwright	1243 Melvin Huston	1264 Anne Passavoy
1224 K. Schaeffer	1244 Larry Mason	1265 Bob Passavoy

as of July 8, 1979